

Technical Specifications

Power Supply	2x 1.5 V AA batteries
Battery Lifetime	up to 10 years
Sensor	Reed contact

Loxone Air Interface

Frequencies & Channels	868 MHz (SRD Band Europe), 4 channels, max. 15.1 mW e.r.p. 915 MHz (ISM Band Region 2), 10 channels, max. 13.2 mW internal antenna
------------------------	--

Ambient Conditions

Temperature	0 ... 55 °C / 32 ... 131 °F
Humidity	max. 95 % r.H. (non condensing)
Ingress Protection	IP20

Information

Contains **FCC ID: 2ARRV-000375**

This device complies with part 15 of the FCC Rules.
Operation is subject to the following two conditions:

1. This device may not cause harmful interference.
2. This device must accept any interference received,
including interference that may cause undesired operation.



For more information
about this product, visit
loxone.com/help/door-window-contact-air

V040825

**Loxone
Electronics GmbH**
Smart Home 1
4154 Kollerschlag
Austria

Loxone UK
The Forum
Station Road
Theale, RG7 4RA
United Kingdom



For additional information,
declaration of conformity, visit
www.loxone.com/datasheets

Need Help?
loxone.com/support



Door & Window Contact Air

Part No.: 100666 (White)
Part No.: 100667 (Anthracite)

LOXONE

About the product

The Loxone Door & Window Contact Air is a compact wireless sensor with an integrated reed contact. In combination with a magnet, it reliably detects open or closed doors and windows – ideal for security and automation functions.

Features

- Discreet design
- Long battery life
- Perfect for retrofitting
- Reliable detection of window and door states
- Seamless integration with alarm, heating, and more

Magnet Installation

Mount the magnet parallel to the Door & Window Contact Air (see illustration).

The maximum distance must be 5 mm for reliable detection.

Any other alignment reduces the detection range.

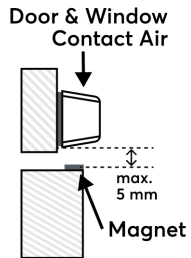

Safety Instructions

This device is free of maintenance and must only be cleaned with a dry cloth.

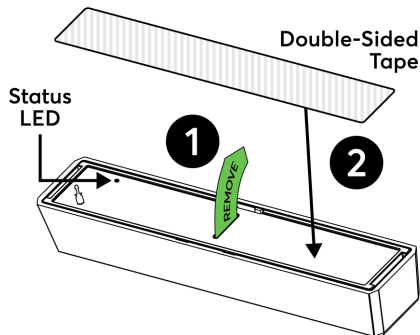

Mount it on the window or door

3

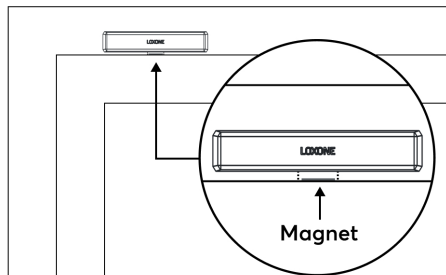

Pairing Mode



Status LED

Pairing Button

Reed Contact

